

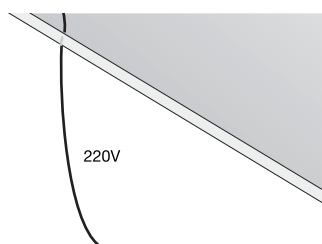

Surface-Mounted Installation

PURATI
Filo Linear Series

- 1** Make the 220V wire go through the ceiling
⚠ Do not touch with wet hands or there is a risk of electric shock



- 2** Prepare all the installation accessories

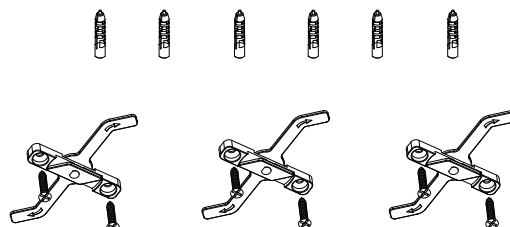

- 3** Measure the distance (L) between the clips, lock the rotating clip, and open the power line hole of the ceiling

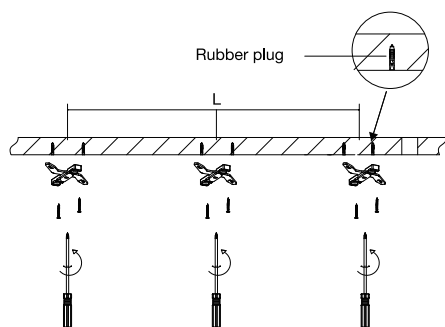

- 4** Rotate the axisy

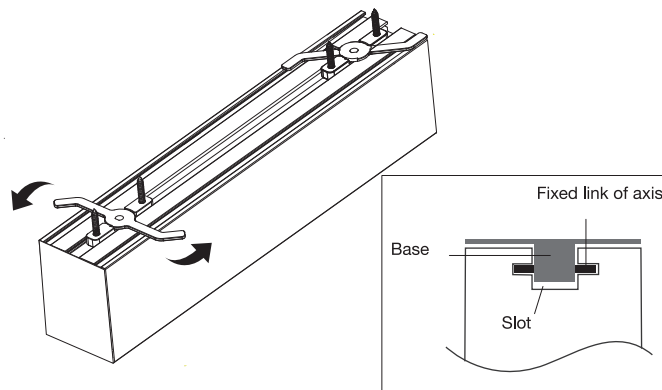

- 5** Finished

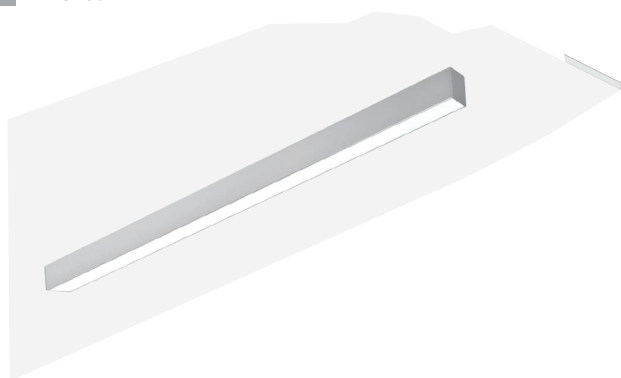



Pendant Installation

PURATI
Filo Linear Series

1 Make the 220V wire go through the ceiling

⚠ Do not touch with wet hands or there is a risk of electric shock

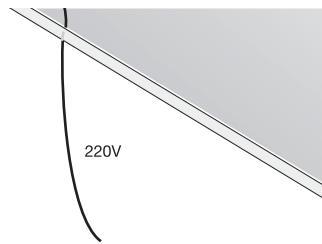

2 Prepare all the installation accessories

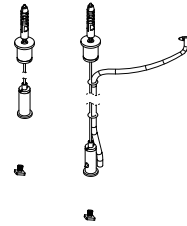

3 Fasten the hardware with dry wall screws

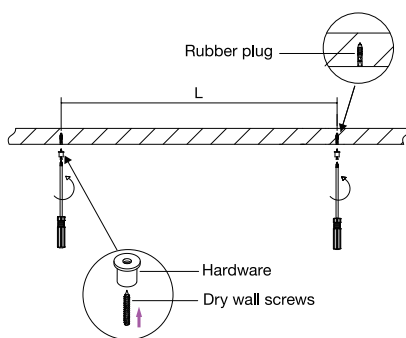

4 Slide the rectangular screw into the profile, adjust it to the corresponding position, and tighten the thread locking device

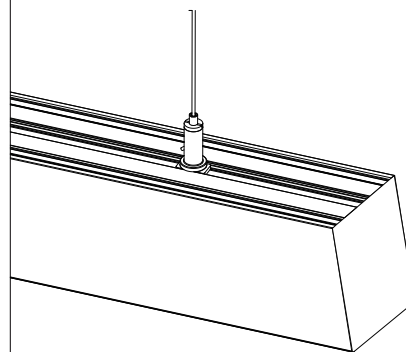

5 Connect the suspension cable to the corresponding position of the ceiling

⚠ (Please make sure that the suspension cable is firmly installed)

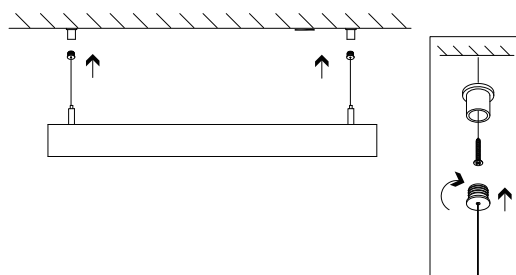

6 Connect the power cord



7 finished

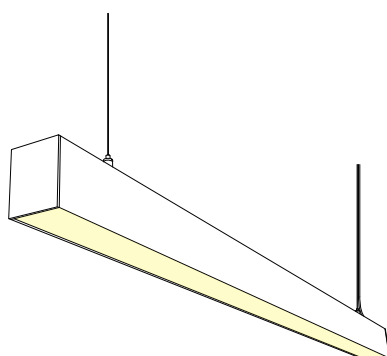



1 Make the 220V wire go through the ceiling

⚠ Do not touch with wet hands or there is a risk of electric shock

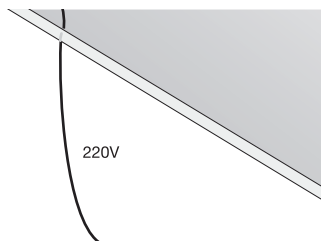

2 Make a slot the same size as the profile on the ceiling

⚠ Dimensional tolerance of slot $\pm 0.5\text{mm}$

Slot size BS5470 L(Profile length+9mm)*W61mm*H110mm

e.g. : The 9mm of BS5470 refers to the thickness of both end caps (2*3.5mm) + 2mm gap

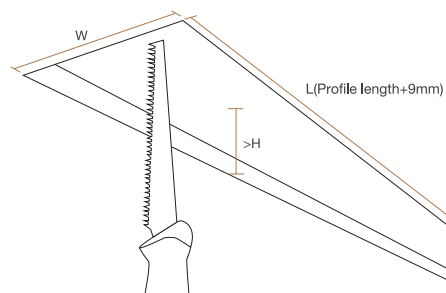

3 Slide the recessed accessories without trim into the profile and then fix it on the profile (adjust the height of recess)

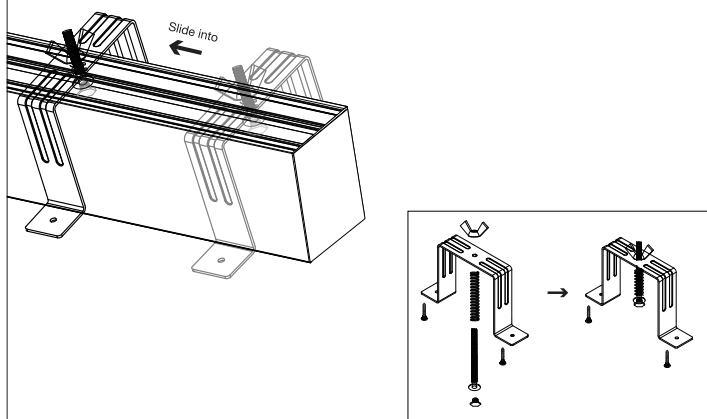

4 Install the profile in the slot of ceiling, and then fix it on the ceiling by recessed clip without trim

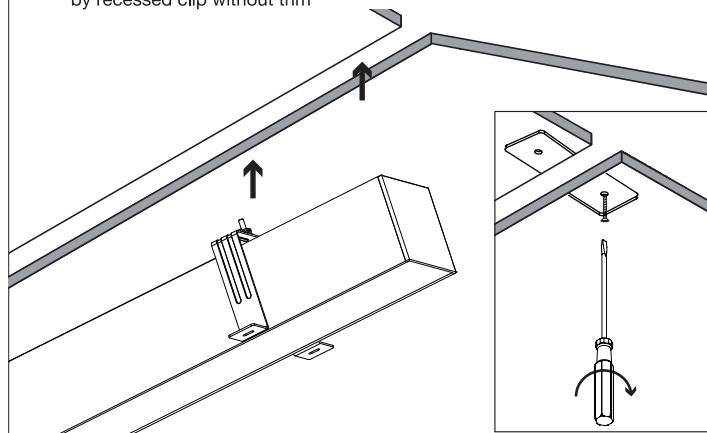

5 Cover the luminous surface with masking tape

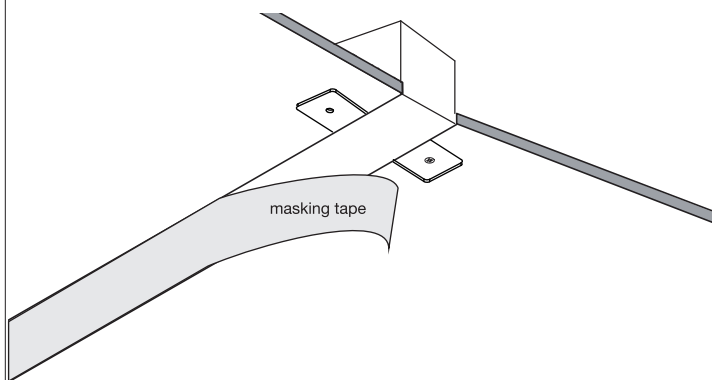

6 Plaster the ceiling to fill the gap

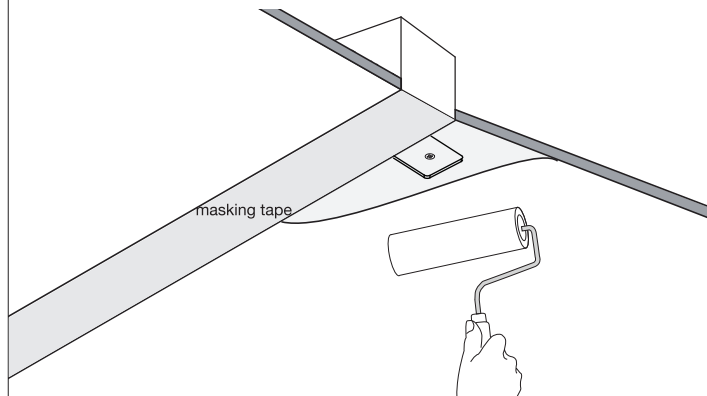

7 Tear off the masking tape and the installation is finished

⚠ Please stop using if there are abnormalities like smoke or burn t flavor occur from the fixtures

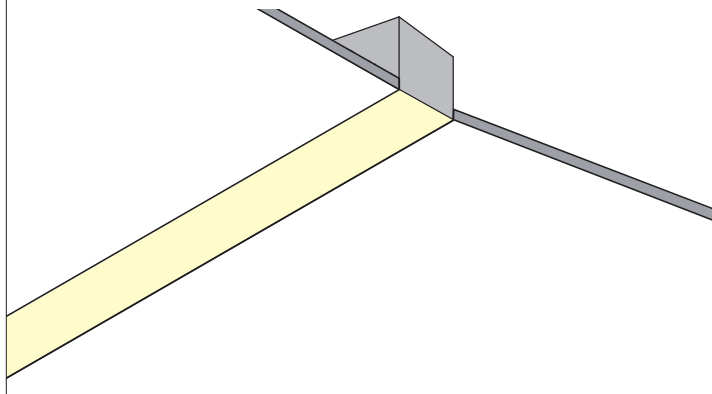

- 1 Internal connecting parts**
Remove the end cap, and then use internal connecting parts to link luminaires

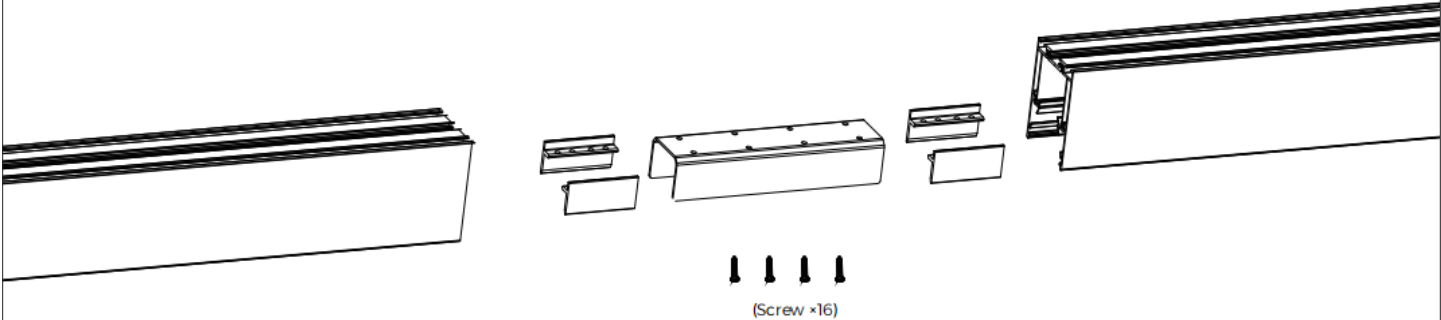

- 1 Whole lamp external connection with end cap**
Use the whole lamp external connecting parts to link the Luminaires

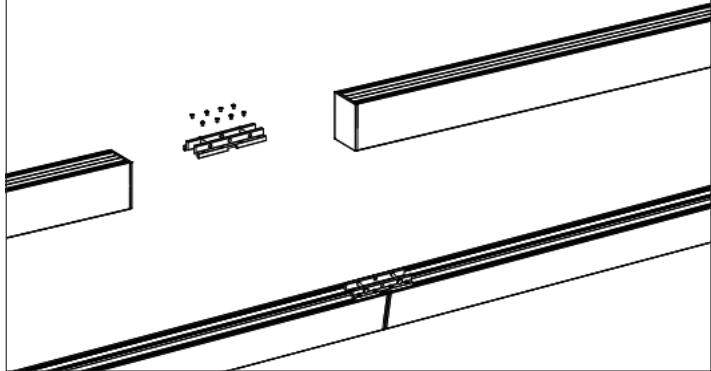

- 2 Whole lamp external connection without end cap**
Use the whole lamp external connecting parts to link the Luminaires

