

PURATI

INSTALLATION GUIDELINES

POINT R Adjustable L

PREPARATION:

- The mains isolator on the consumer unit/fuse board must be in "OFF" position before commencing any electrical work.
- The luminaire should be mounted on a flat, smooth surface.
- With all painted / plated products some shade and finishing variation may occur, please make sure luminaires are checked before installation.
- The manufacturer reserves the right to improve the product specification without prior notice.



Do not directly cover
fitting with insulation.



CE IP20

Installation must be done by a qualified electrician.

DRIVER

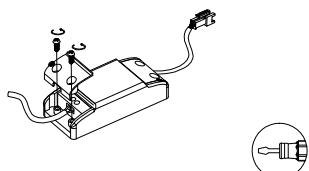

FRONT SIDE

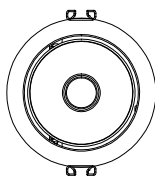

PROFILE

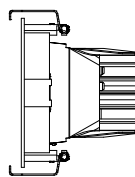

CONNECTION PREVIEW

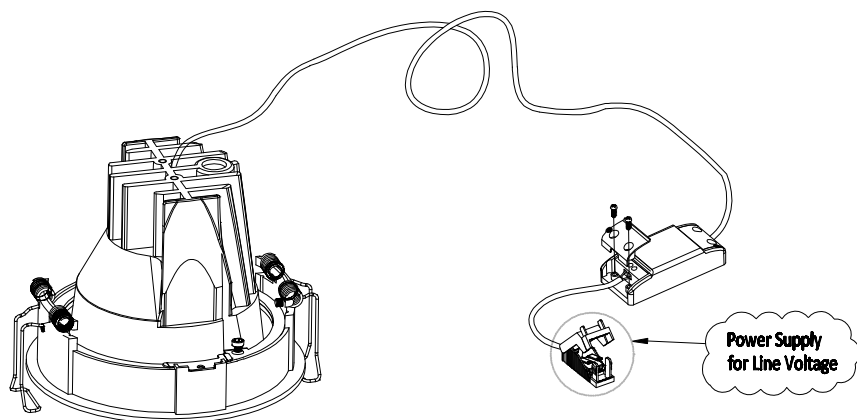

Quick Connection

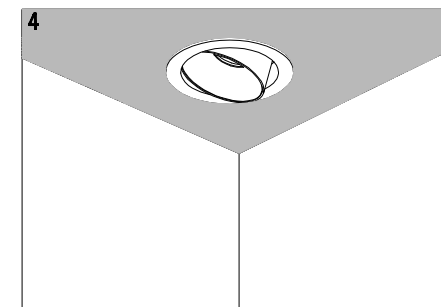
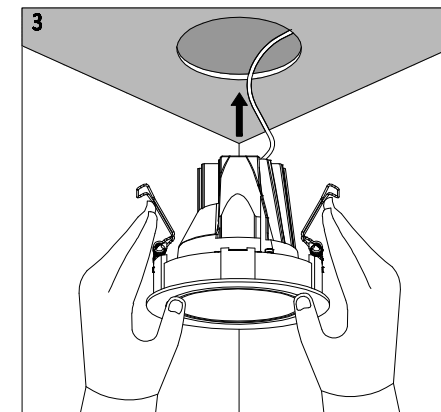
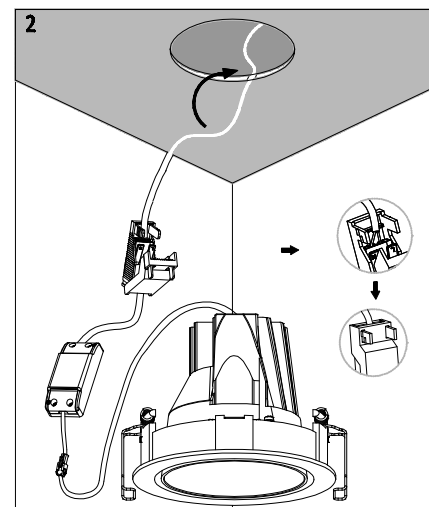
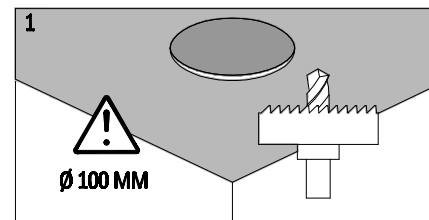
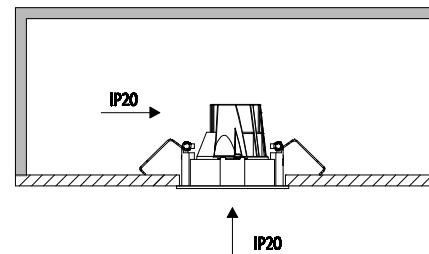
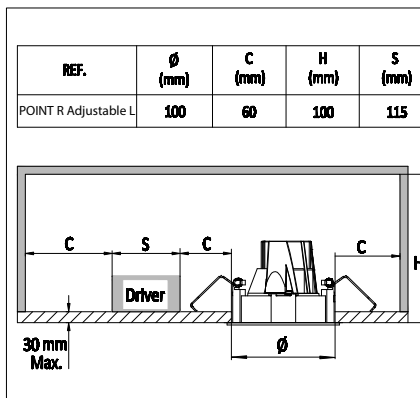

UNINSTALL

